

Seuils de conformité
 Cu 1 000 µg/l
 Pb 10 µg/l
 Ni 20 µg/l

Bâti.H

Dépôt labo Mme Bonnet						
	8/12	16/12	7/01	23/02	11/03	23/03
Cu	●	●	●	●	●	●
Pb	●	●	●	●	●	●
Ni	●	●	●	●	●	●

Bâti.O

Salle des professeurs collège						
	8/12	16/12	7/01	23/02	11/03	23/03
Cu	●	●	●	●	●	●
Pb	●	●	●	●	●	●
Ni	●	●	●	●	●	●

Bâti.M

Sanitaire des 300						
	8/12	16/12	7/01	23/02	11/03	23/03
Cu	●	●	●	●	●	●
Pb	●	●	●	●	●	●
Ni	●	●	●	●	●	●

Bâti.M

Préparation labo 500						
	8/12	16/12	7/01	23/02	11/03	23/03
Cu	●	●	●	●	●	●
Pb	●	●	●	●	●	●
Ni	●	●	●	●	●	●

Bâti.P

Self légumerie						
	8/12	16/12	7/01	23/02	11/03	23/03
Cu	●	●	●	●	●	●
Pb	●	●	●	●	●	●
Ni	●	●	●	●	●	●

Self marmite						
	8/12	16/12	7/01	23/02	11/03	23/03
Cu	●	●	●	●	●	●
Pb	●	●	●	●	●	●
Ni	●	●	●	●	●	●

Self réfectoire						
	8/12	16/12	7/01	23/02	11/03	23/03
Cu	●	●	●	●	●	●
Pb	●	●	●	●	●	●
Ni	●	●	●	●	●	●

Bâti.C

Infirmierie collège						
	8/12	16/12	7/01	23/02	11/03	23/03
Cu	●	●	●	●	●	●
Pb	●	●	●	●	●	●
Ni	●	●	●	●	●	●

Infirmierie lycée						
	8/12	16/12	7/01	23/02	11/03	23/03
Cu	●	●	●	●	●	●
Pb	●	●	●	●	●	●
Ni	●	●	●	●	●	●

Sanitaire 1er étage						
	8/12	16/12	7/01	23/02	11/03	23/03
Cu	●	●	●	●	●	●
Pb	●	●	●	●	●	●
Ni	●	●	●	●	●	●

Bâti.K

Appartement K0						
	8/12	16/12	7/01	23/02	11/03	23/03
Cu	●	●	●	●	●	●
Pb	●	●	●	●	●	●
Ni	●	●	●	●	●	●

Appartement K1						
	8/12	16/12	7/01	23/02	11/03	23/03
Cu	●	●	●	●	●	●
Pb	●	●	●	●	●	●
Ni	●	●	●	●	●	●

Bâti.Q

Gymnase lycée						
	8/12	16/12	7/01	23/02	11/03	23/03
Cu	●	●	●	●	●	●
Pb	●	●	●	●	●	●
Ni	●	●	●	●	●	●

Cité scolaire de Digoin

Historique des résultats des analyses de l'eau aux 1^{er} et 2^e jets (cuivre - plomb - nickel)

- analyses conformes aux 1^{er} et 2^e jets
- analyses non conformes aux 1^{er} et 2^e jets
- analyses non conformes au 1^{er} jet - conformes au 2^e jet
- analyses conformes au 1^{er} jet - non conformes au 2^e jet
- analyses conformes aux 1^{er}, pas de 2^e jet

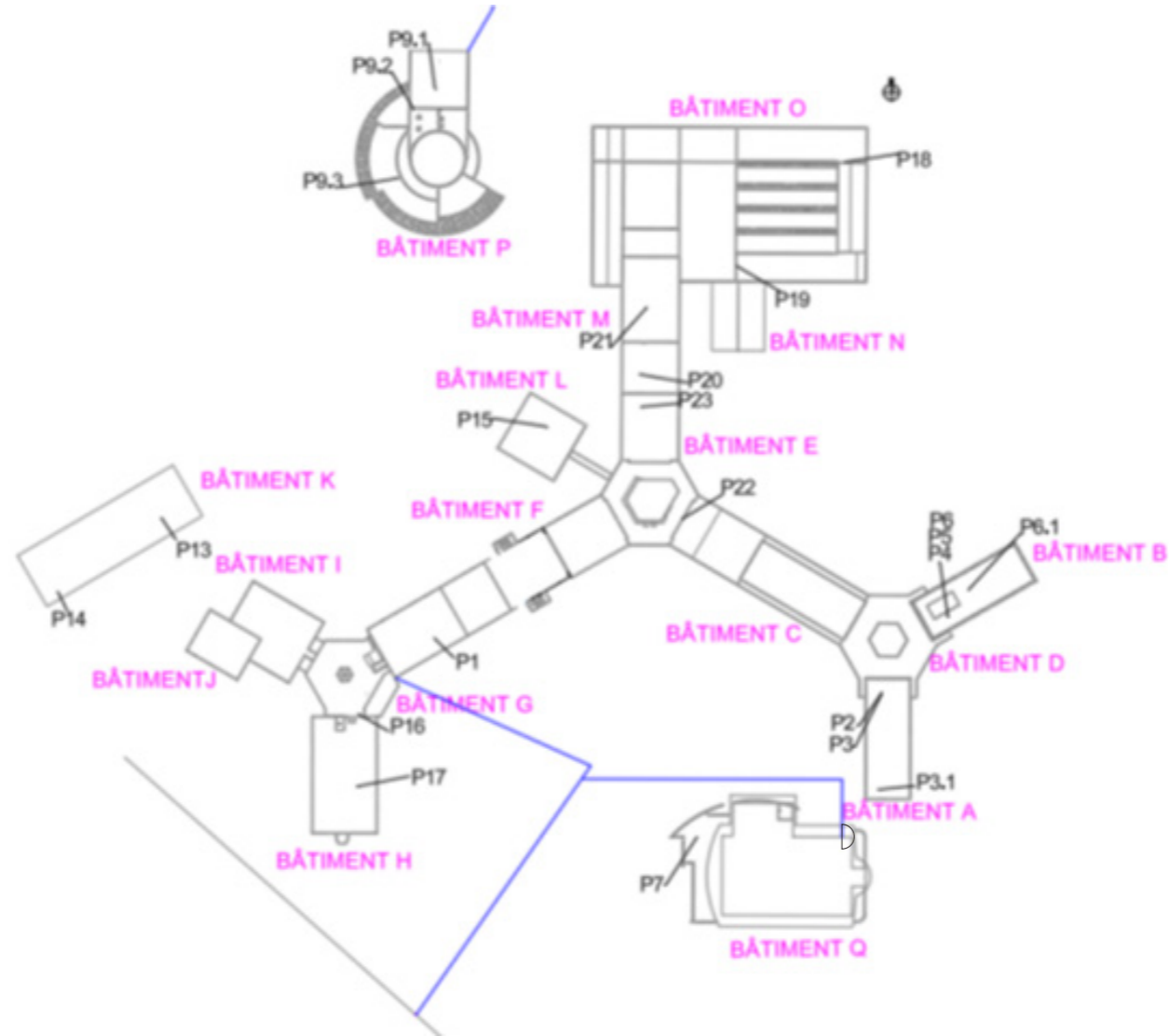

Bâti.F

Toilettes collège garçon						
	8/12	16/12	7/01	23/02	11/03	23/03
Cu	●	●	●	●	●	●
Pb	●	●	●	●	●	●
Ni	●	●	●	●	●	●

Bâti.L

Administration lycée						
	8/12	16/12	7/01	23/02	11/03	23/03
Cu	●	●	●	●	●	●
Pb	●	●	●	●	●	●
Ni	●	●	●	●	●	●

Bâti.B

Dortoir 3						
	8/12	16/12	7/01	23/02	11/03	23/03
Cu	●	●	●	●	●	●
Pb	●	●	●	●	●	●
Ni	●	●	●	●	●	●

Dortoir 4						
	8/12	16/12	7/01	23/02	11/03	23/03
Cu	●	●	●	●	●	●
Pb	●	●	●	●	●	●
Ni	●	●	●	●	●	●

Dortoir 5 - évier tisanerie - robinet purge automatique						
	8/12	16/12	7/01	23/02	11/03	23/03
Cu	●	●	●	●	●	●
Pb	●	●	●	●	●	●
Ni	●	●	●	●	●	●

Dortoir 5 - évier tisanerie - mélangeur						
	8/12	16/12	7/01	23/02	11/03	23/03
Cu	●	●	●	●	●	●
Pb	●	●	●	●	●	●
Ni	●	●	●	●	●	●

Vestiaire agents de ménage						
	8/12	16/12	7/01	23/02	11/03	23/03
Cu	●	●	●	●	●	●
Pb	●	●	●	●	●	●
Ni	●	●	●	●	●	●

Bâti.A

Pied de colonne dortoir vide sanitaire						
	8/12	16/12	7/01	23/02	11/03	23/03
Cu	●	●	●	●	●	●
Pb	●	●	●	●	●	●
Ni	●	●	●	●	●	●

Dortoir 1						
	8/12	16/12	7/01	23/02	11/03	23/03
Cu	●	●	●	●	●	●
Pb	●	●	●	●	●	●
Ni	●	●	●	●	●	●

Dortoir 2						
	8/12	16/12	7/01	23/02	11/03	23/03
Cu	●	●	●	●	●	●
Pb	●	●	●	●	●	●
Ni	●	●	●	●	●	●

Bâti.G

Administration collège						
	8/12	16/12	7/01	23/02	11/03	23/03
Cu	●	●	●	●	●	●
Pb	●	●	●	●	●	●
Ni	●	●	●	●	●	●

Bâti.E

Atelier agents de maintenance						
	8/12	16/12	7/01	23/02	11/03	23/03
Cu	●	●	●	●	●	●
Pb	●	●	●	●	●	●
Ni	●	●	●	●	●	●

Salle des professeurs lycée						
	8/12	16/12	7/01	23/02	11/03	23/03
Cu	●	●	●	●	●	●
Pb	●	●	●	●	●	●
Ni	●	●	●	●	●	●